

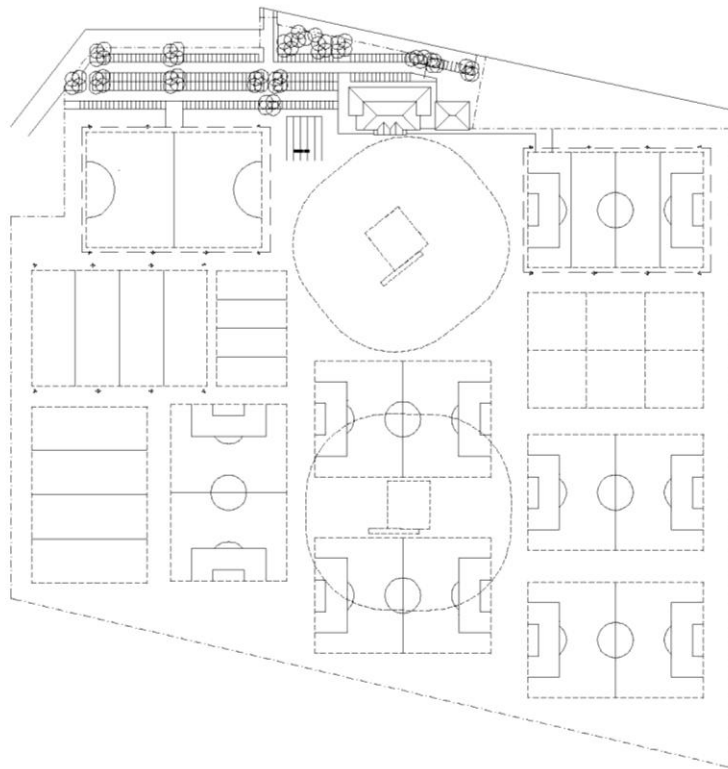

"FOR THE COMMUNITY, BY THE COMMUNITY"



**OUR VISION FOR
THE FUTURE OF
COMMUNITY
SPORT IN THE
SOUTH OF BATH**

“FOR THE COMMUNITY, BY THE COMMUNITY”

Who are we?



The key partners are a group of local sports clubs and community organisations that share the same values, principles and vision for the future of Odd Down Playing Fields:

- ❑ Old Culverhaysians RFC
- ❑ Hampset CC
- ❑ Bath Arsenal Juniors FC
- ❑ Culverhay School
- ❑ [Bath BMX Club]



The group is actively seeking new partners from different sport such as cycling, running and boxing to join the group to widen the range of skillsets involved in the project.

“FOR THE COMMUNITY, BY THE COMMUNITY”

What is our shared vision?

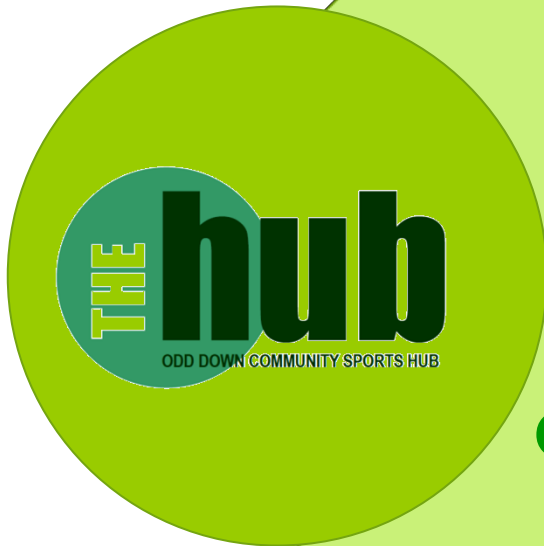

“Through working together, we strive to establish a modern sporting venue in the South of Bath to foster development of a range of sports at local, grassroots level.”

“FOR THE COMMUNITY, BY THE COMMUNITY”

What are our aims? (and your aims)



Provide sporting opportunities for all ages and abilities in a safe, friendly environment.

Protect a valuable, diverse green space and preserve it for future generations.

Use sport as a powerful agent for good in the lives of the local people .

Provide a hub for health, education, youth and the community in BANES.

Deliver many of BANES' own strategies and aims.

Provide a valuable community resource - in an area of genuine need.

Provide good quality, affordable sports facilities for all.

Provide a permanent home for community sports clubs.

Deliver Sport England's objective of providing a hub club within 20mins of each person.

“FOR THE COMMUNITY, BY THE COMMUNITY”

These will be achieved by:



- Appointing a suitably experienced, qualified and motivated Board of Trustees.
- Creating a Hub where everyone contributes and everyone takes responsibility.
- Using a huge volunteer resource of existing players, coaches, officials and supporters.
- Developing strong relationships with schools, community groups, clubs and residents.
- Continuing to work closely with BANES Councillors and Officers.
- Attracting funding for further development through sources not accessible by BANES.
- Developing a facility that will be professionally managed.
- Promoting open access to the local community.
- Seeking Sport England accreditation as a QE2 pitch.

“FOR THE COMMUNITY, BY THE COMMUNITY”

What sports facilities form part of our vision?



- ❑ 1 floodlit 3rd Generation Synthetic Turf Pitch (STP)
- ❑ Multiple junior football pitches
- ❑ 5 adult football pitches
- ❑ 1 floodlit adult rugby pitch
- ❑ 1 junior rugby pitch
- ❑ 1 cricket pitch
- ❑ Cricket nets
- ❑ Tarmac cycle track
- ❑ BMX track

“FOR THE COMMUNITY, BY THE COMMUNITY”

What sports facilities form part of our vision?



“FOR THE COMMUNITY, BY THE COMMUNITY”

What indoor facilities form part of our vision?



An community pavilion with:

- ❑ Multiple changing rooms
- ❑ Offices and committee rooms
- ❑ Large multi-function room
- ❑ Disabled facilities
- ❑ Community café
- ❑ Health and fitness gym
- ❑ First aid/treatment room

“FOR THE COMMUNITY, BY THE COMMUNITY”

What indoor facilities form part of our vision?

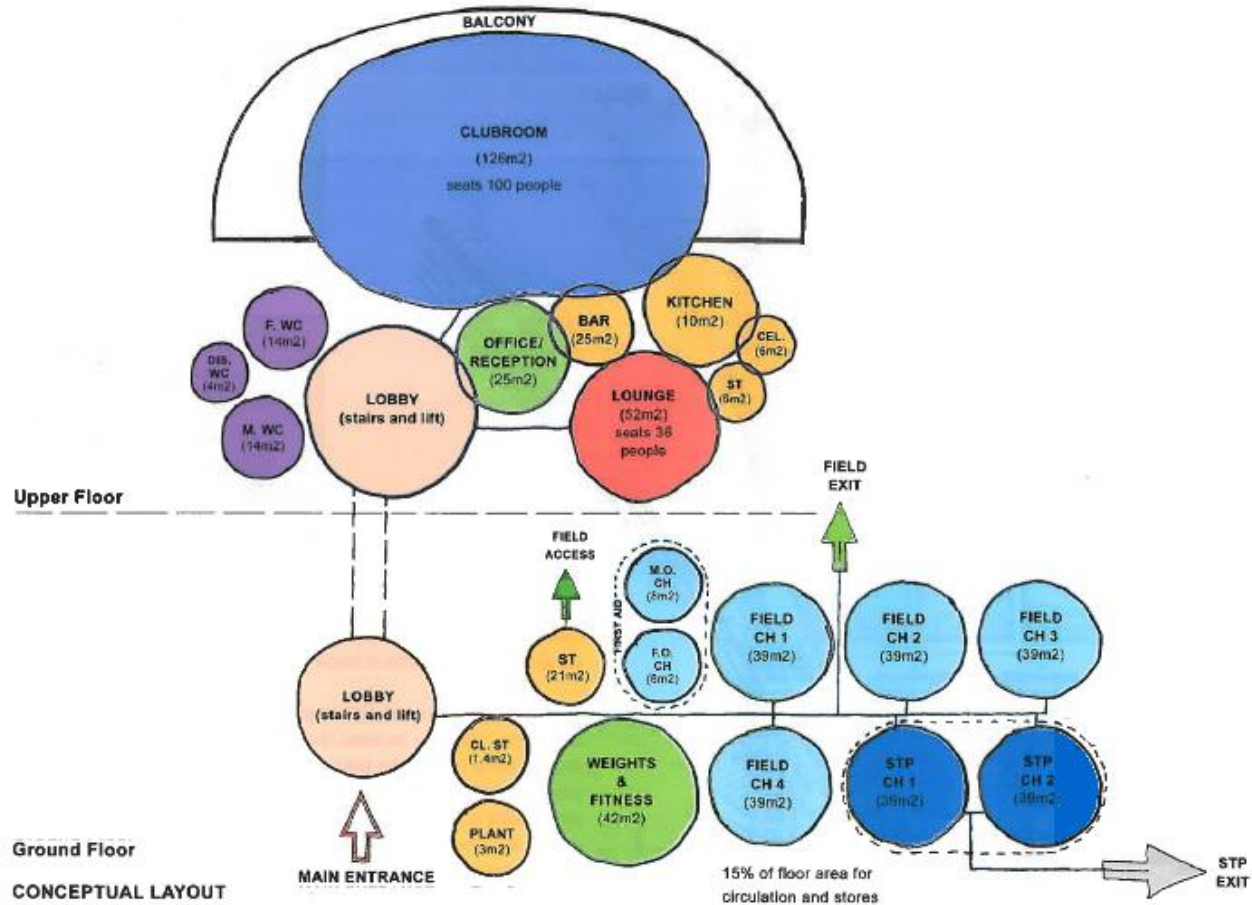

“FOR THE COMMUNITY, BY THE COMMUNITY”

Potential funding sources



- | | |
|---|--|
| <input type="checkbox"/> Sainsbury's S106 money | <input type="checkbox"/> £1,200,000 |
| <input type="checkbox"/> British Cycling | <input type="checkbox"/> £ 450,000 |
| <input type="checkbox"/> Performance Reward Grant | <input type="checkbox"/> £ 150,000 |
| <input type="checkbox"/> Protecting Playing Fields | <input type="checkbox"/> £ 50,000 |
| <input type="checkbox"/> Pitch Improvement | <input type="checkbox"/> £ 50,000 |
| <input type="checkbox"/> Other Grant Sources | <input type="checkbox"/> £ 200,000 |
| <input type="checkbox"/> Sponsorship | <input type="checkbox"/> £ 100,000 |
| | <input type="checkbox"/> <u>£2,200,000</u> |
|
 | |
| <input type="checkbox"/> Shortfall (existing running costs over 10yrs) | <input type="checkbox"/> £ 300,000 |

“FOR THE COMMUNITY, BY THE COMMUNITY”

Potential funding sources



Client:
York Cricket and Rugby Union FC

Value:
£990,000

Area:
8,500sqft

Duration:
48 weeks

Completion:
September 2009

Procurement:
Design and Build

Architect:
GMI Construction Group PLC

Structural Engineer:
3E Consulting Engineers

This project provides a two storey sports facility for York Cricket and Rugby Union FC. The work included the partial demolition of the existing changing rooms, whilst retaining the members bar area. Car and coach parking, all associated drainage, incoming services, landscaping and ancillary works were provided.

The ground floor provides an entrance lobby, six changing areas, including showers, official changing rooms, physio room, disabled hoist, toilet accommodation, cellar room and groundsman store.

The first floor provides the main club room with a glass fronted elevation and balcony overlooking the playing fields, bar, kitchen/servery, meeting room and toilet accommodation.



12/12/2011

Leading football chairmen open new football facilities in Birmingham

The chairman of The Football Association, David Bernstein, and new Football Foundation chairman Gary Hoffman were in Birmingham to officially open a new third generation (3G) artificial grass pitch and changing room pavilion at Boldmere Falcons in Sutton Coldfield.

The Foundation contributed £464,129 towards the total cost of £862,129 of the new facilities, with a further £250,000 provided by the FA Whole Sport Plan Funding.

“FOR THE COMMUNITY, BY THE COMMUNITY”

We want/need...



- ✓ The endorsement of BANES Council
- ✓ A true partnership with our local authority
- ✓ A strong voice at the planning table
- ✓ Early and visible progress
- ✓ Establishment of key dates & timelines
- ✓ Financial support towards shortfall
- ✓ Support on completing legal processes
- ✓ Support on bid writing/sourcing funds
- ✓ Support in setting up a realistic management model
- ✓ Support in securing backing of local residents
- ✓ Share our ambitious vision

“FOR THE COMMUNITY, BY THE COMMUNITY”